

CONTACT CONFIGURATION
TIMING (BBM) NON-SHORTING

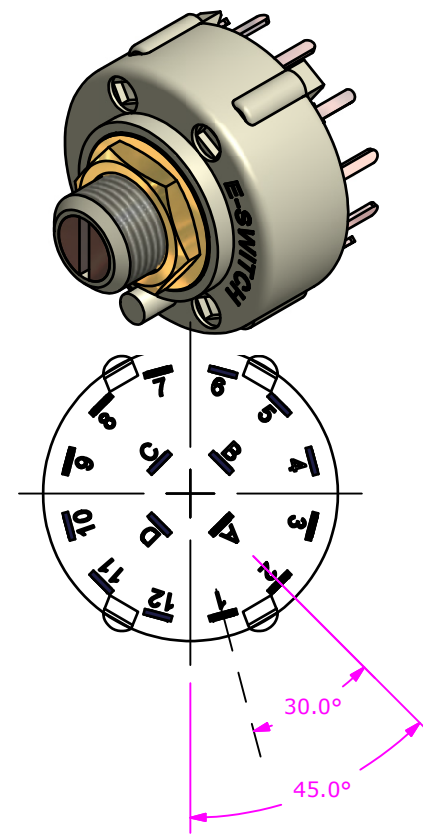

NOTE:

1. ALL DIMENSIONS IN MM[INCH].
2. GENERAL TOLERANCE: X.X=±0.4
X.XX=±0.25
3. TERM. NOS. FOR REFERENCE ONLY.
4. CONTACT MATERIAL: SILVER
5. CONTACT RATING: 150MILLIAMP, 250VAC/DC
350MILLIAMP, 110VAC/DC
6. TIMING: NON-SHORTING
7. OPERATING FORCE 0.8±0.3 kg-cm
8. OPERATING TEMP: -30°C TO 85°C
- ▲9. CIRCUIT SP: 3 POSITION 30° INDEX.
10. DIELECTRIC STRENGTH: 1000V RMS MIN.@ SEA LEVEL.
- ▲11. HARDWARE SUPPLIED ON SWITCH:
LOCKWASHER, HEXNUT, LOCK RING
12. ▲ DENOTES CRITICAL PARAMETER.
13. 2002/95/EC (ROHS) COMPLIANT

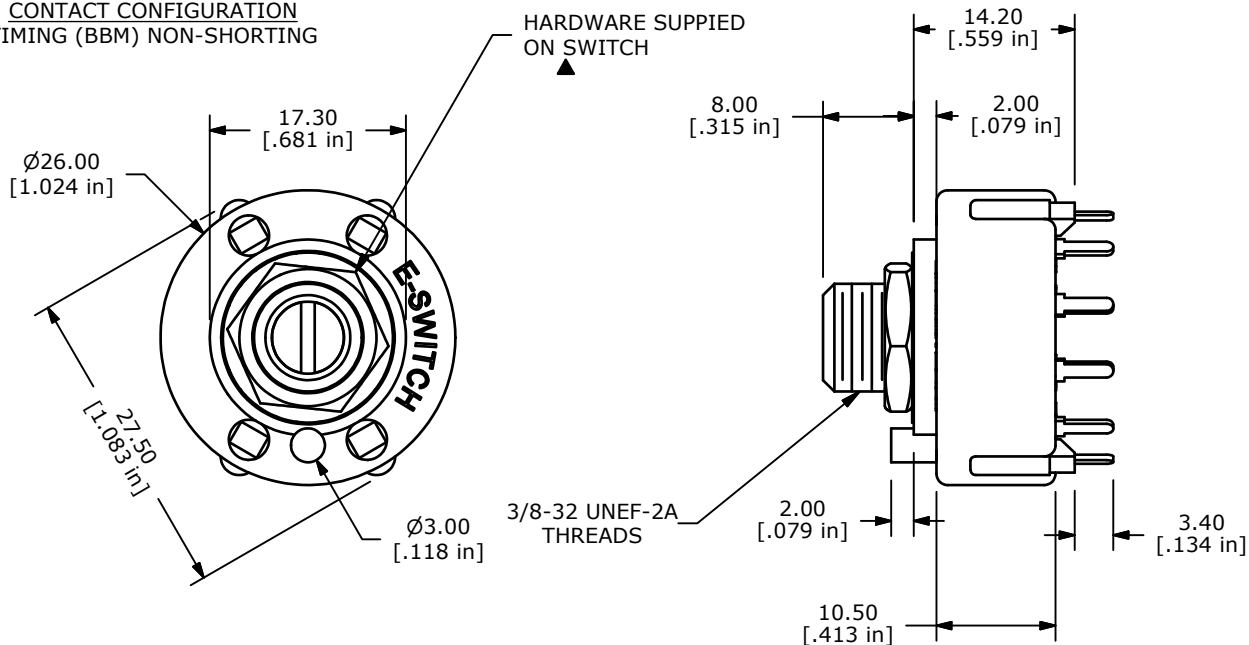
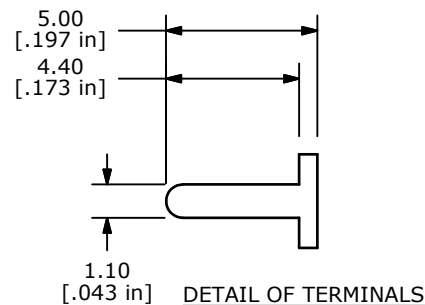

A	21719	RELEASED FOR PRODUCTION	11/14/14	rc
REV	PCR NO	DESCRIPTION	DATE	BY

TITLE KC43D0.001NPS				
SCALE	DATE	DR	DWG	REV
1.5:1	11/14/2014	rc	G510284	A

THE INFORMATION CONTAINED IN THIS DOCUMENT IS PROPRIETARY TO E-SWITCH AND IS NOT TO BE COPIED OR TRANSFERRED